

# **ENERGY<sup>®</sup>**

*Manufacturing Company, Inc.*

## **CYR SERIES MEDIUM DUTY CUSTOM WELDED HYDRAULIC CYLINDERS**

**2.0 Inch (5.08cm) to 8.0 Inch (20.3 cm) Bores – Up to 15.0 Foot (4.57 m) Strokes**



**FOR WORKING PRESSURES TO 3,400 PSIG (235 BAR)**

# CYR CYLINDER DESIGN

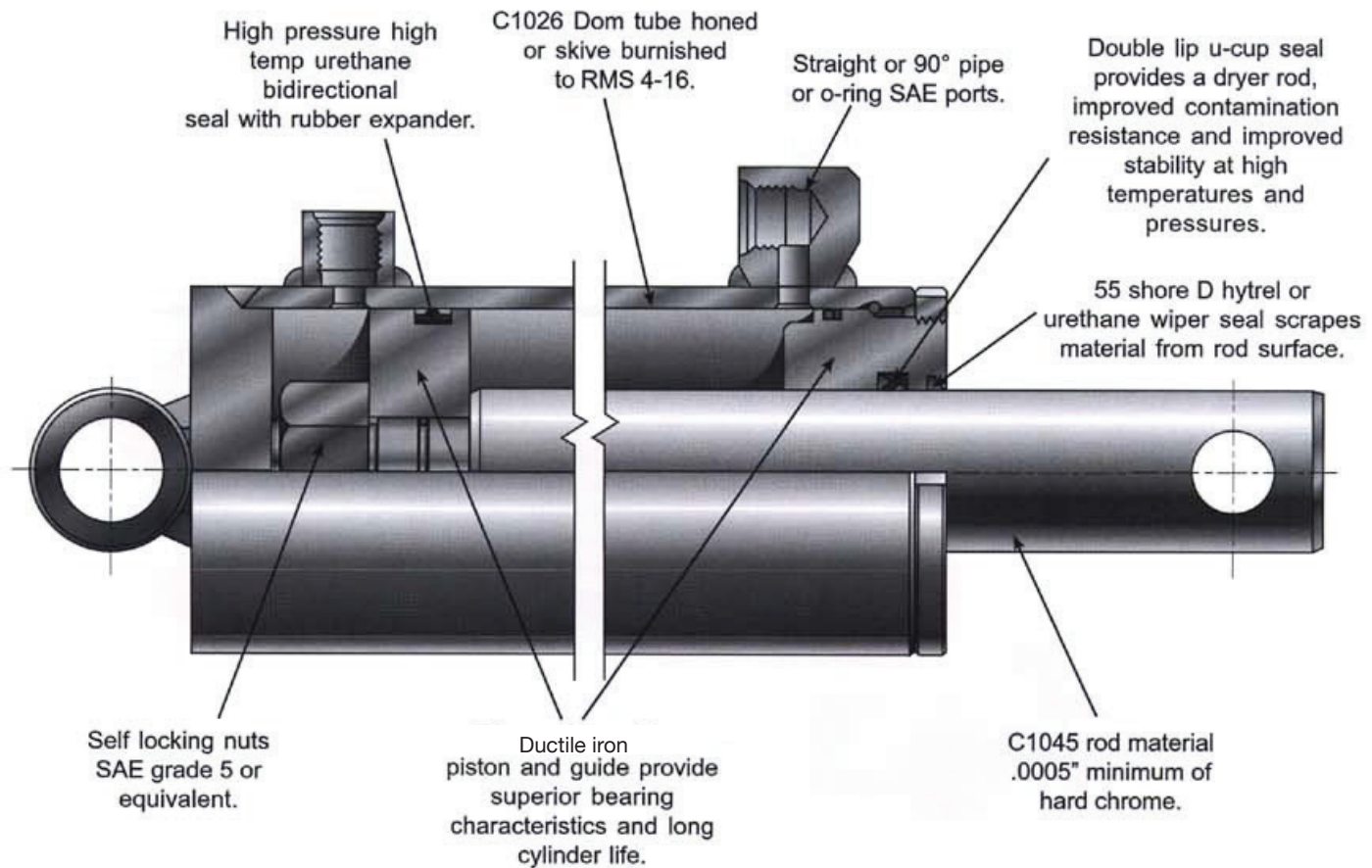

## BASE (B1-B9) AND ROD (R1-R9) ENDS

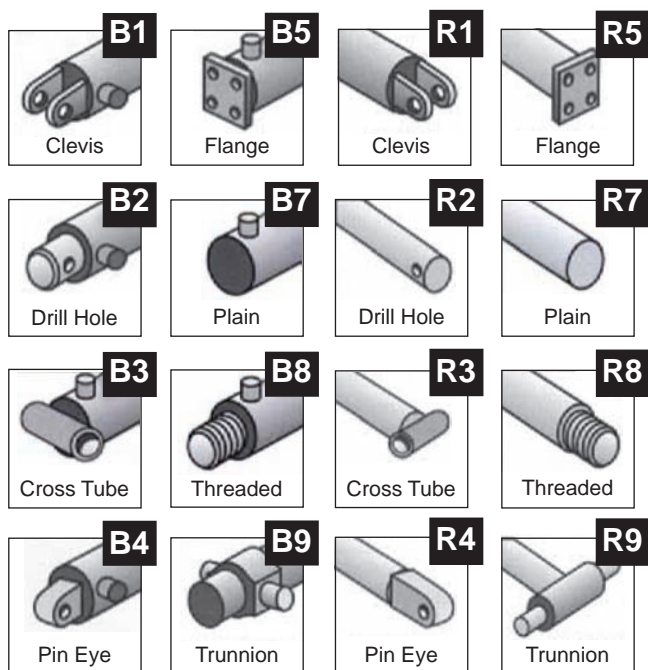

NOTE: Custom base and rod ends, as well as other custom cylinder features, may be available upon request. Please contact our factory for additional information.

## CYR CYLINDER DIMENSIONS

| Bore Diameter   | Available Rod Diameters  |
|-----------------|--|
| 2" (5.08 cm)    | 1" (2.54 cm), 1.125" (2.86 cm), 1.25" (3.18 cm)  |
| 2.25" (5.72 cm) | 1" (2.54 cm), 1.125" (2.86 cm), 1.5" (3.81 cm)   |
| 2.5" (6.35 cm)  | 1.125" (2.86 cm), 1.25" (3.18 cm), 1.375" (3.49 cm), 1.5" (3.81 cm), 1.75" (4.45 cm)                                 |
| 2.75" (6.99 cm) | 1.125" (2.86 cm), 1.25" (3.18 cm), 1.375" (3.49 cm), 1.5" (3.81 cm), 1.625" (4.13 cm), 1.75" (4.45 cm), 2" (5.08 cm) |
| 3" (7.62 cm)    | 1.125" (2.86 cm), 1.25" (3.18 cm), 1.375" (3.49 cm), 1.5" (3.81 cm), 1.75" (4.45 cm), 2" (5.08 cm)                   |
| 3.25" (8.26 cm) | 1.25" (3.18 cm)  |
| 3.5" (8.89 cm)  | 1.25" (3.18 cm), 1.5" (3.81 cm), 1.75" (4.45 cm), 2" (5.08 cm), 2.25" (5.72 cm), 2.5" (6.35 cm)                      |
| 4" (10.16 cm)   | 1.5" (3.81 cm), 1.75" (4.45 cm), 2" (5.08 cm), 2.5" (6.35 cm), 2.75" (6.99 cm)                                       |
| 4.5" (11.43 cm) | 1.75" (4.45 cm), 2" (5.08 cm), 2.5" (6.35 cm), 3" (7.62 cm)  |
| 5" (12.7 cm)    | 1.75" (4.45 cm), 2" (5.08 cm), 2.25" (5.72 cm), 2.5" (6.35 cm), 3" (7.62 cm), 3.5" (8.89 cm)                         |
| 5.5" (13.97 cm) | 2" (5.08 cm), 2.25" (5.72 cm)  |
| 6" (15.24 cm)   | 2" (5.08 cm), 2.5" (6.35 cm), 2.75" (6.99 cm), 3" (7.62 cm), 3.5" (8.89 cm), 4" (10.16 cm), 4.5" (11.43 cm)          |
| 7"              | 2" (5.08 cm), 2.5" (6.35 cm)   |
| 8"              | 2.5" (6.35 cm), 2.75" (6.99 cm), 3.5" (8.89 cm)  |

Please consult factory if the bore/rod combination you desire is not shown above.

## CYR DESIGN OPTIONS & SPECIAL PORT BLOCKS

### SPECIAL VALVE BLOCK (BOLTED ON)

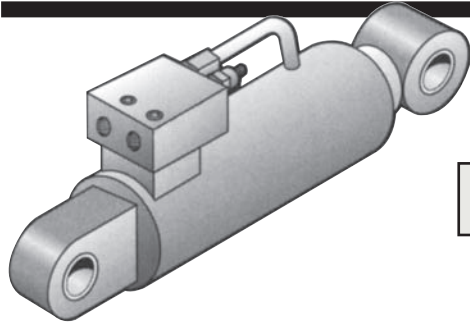

*Illustration is one typical example.  
For other options consult factory.*

### SPECIAL VALVE BLOCK IN BASE END

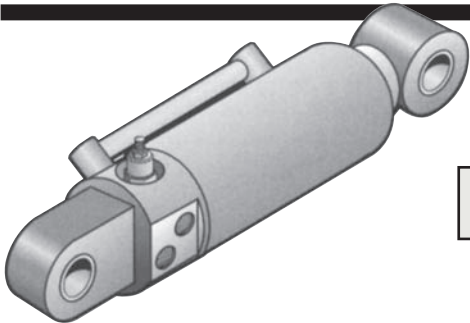

*Illustration is one typical example.  
For other options consult factory.*

### PORT OPTIONS AVAILABLE

- **Standard SAE O-Ring Ports:**  
Available in straight, 90° elbow, and several other configurations
- **NPTF Ports:**  
Available in straight, 90° elbow, and several other configurations
- **4-Bolt Flange Ports:**  
Please consult factory for availability

### ADDITIONAL AVAILABLE FEATURES:

- Single-acting cylinders
- Ram-type cylinders
- Custom end mechanisms
- Custom fluid lines
- Hydraulic cushioning
- Integral stop tubes
- Custom valve blocks and valves
- Position sensing cylinders
- Re-phasing cylinders

## ENERGY MANUFACTURING CUSTOM WELDED CYLINDER EXAMPLES

